

# 1

- |                             |                              |
|-----------------------------|------------------------------|
| (GB) Attach velcro          | (SE) Sätt fast kardborreband |
| (DE) Klettband befestigen   | (NO) Fest borrelås           |
| (FR) Fixer la bande         | (DK) Påsæt velcro            |
| (NL) Klittenband bevestigen | (FI) Kiinnitä tarra          |
| (ES) Pegar velcro           | (PL) Mocowanie na rzep       |
| (IT) Velcro adesivo         | (CZ) Lepící plocha           |
| (PT) Fixar com velcro       | (HU) Erősítse tépózáras      |
| (GR) Ταινία velcro σύνδεσης | (SRB) Čičak traka            |

## A

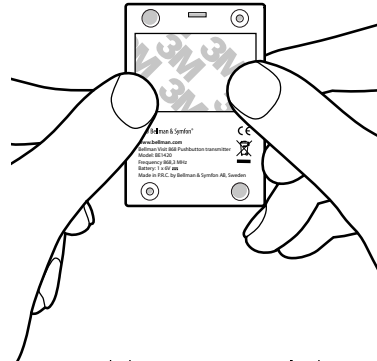

## B

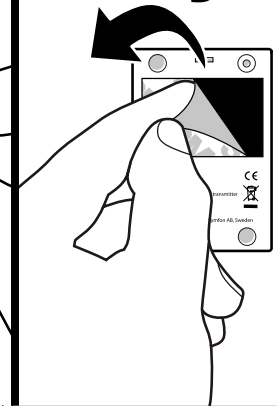

# 2

- |                    |                    |
|--------------------|--------------------|
| (GB) Mount         | (SE) Montera       |
| (DE) Montieren     | (NO) Montering     |
| (FR) Se placer     | (DK) Montere       |
| (NL) Montage       | (FI) Kiinnitys     |
| (ES) Montar        | (PL) Instalacja    |
| (IT) Montaggio     | (CZ) Držák         |
| (PT) Montagem      | (HU) Rögzítés      |
| (GR) Συναρμολόγηση | (SRB) Postavljanje |

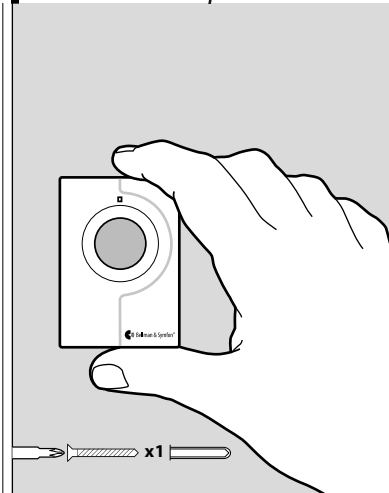
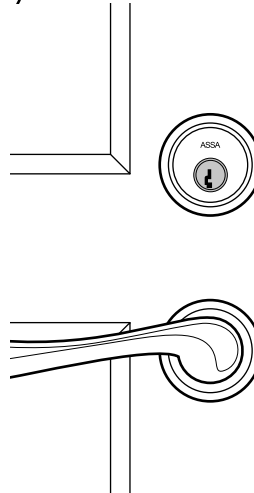

# 3

- |              |                 |
|--------------|-----------------|
| (GB) Test    | (SE) Testa      |
| (DE) Testen  | (NO) Testing    |
| (FR) Tester  | (DK) Test       |
| (NL) Test    | (FI) Testaus    |
| (ES) Probar  | (PL) Testowanie |
| (IT) Prova   | (CZ) Test       |
| (PT) Testar  | (HU) Tesztelés  |
| (GR) Έλεγχος | (SRB) Provera   |

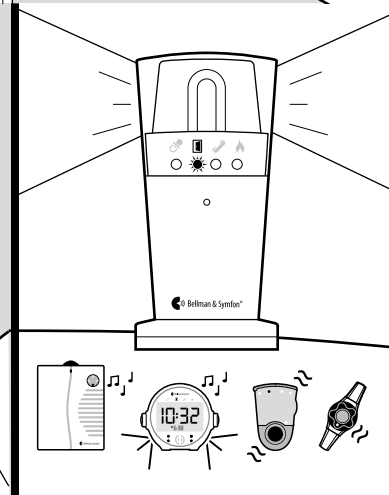
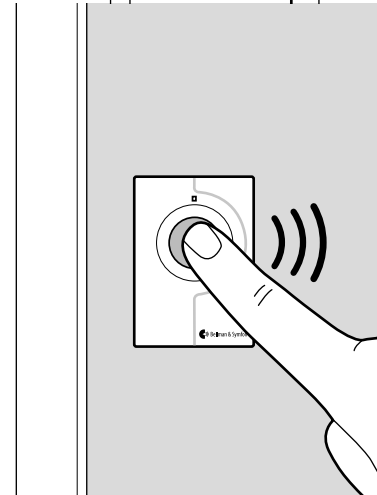

Bellman & Symfon Asia Ltd.  
1401-06, Main Tower, GD Int'l Bldg  
339 Huanshi Dong Rd  
Guangzhou, China, 510095  
Phone: +86 20 8318 2950  
Fax: +86 20 8333 5528  
E-mail: info.cn@bellman.com

Bellman & Symfon North America Inc.  
5509 Business Dr, Unit B  
Wilmington, NC 28405  
Unites States  
Phone: +1 (910) 239 5796  
Toll-free: + (833) 235 5626  
E-mail: support.bsn@bellman.com



## Manufacturer

Bellman & Symfon Group AB  
Södra Långebergsgatan 30  
436 32 Askim Sweden  
Phone +46 31 68 28 20  
E-mail info@bellman.com  
bellman.com



Revision: BE1420\_020MAN014  
Date of issue: 2021-04-07  
TM and © 2021 Bellman & Symfon AB.  
All rights reserved.

 Bellman & Symfon®  
DESIGN FOR EARS

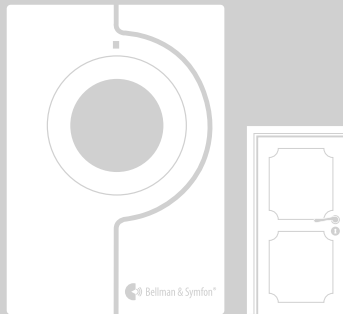

## General information

Power supply  
Power consumption  
Operating time  
Radio frequency  
Coverage

Number of radio keys  
Usage and storage  
Maintenance and cleaning

Warranty and service

Operating temperature  
Transport and storage temp.  
Relative humidity

## Allgemeine Informationen

Zweckbestimmung des Produktes  
Zulässige Betriebsbedingungen

Reinigungshinweise  
Wartungshinweise

Technische Daten  
Hinweise zum Wiedereinsatz

Battery power: PX28G/PX28M alkaline or 6V PX28L lithium  
Active 35 mA, Idle position < 0,05 µA  
Alkaline ~ 2 years, Lithium ~ 4 years  
314.91 MHz, 433.92 MHz or 868.3 MHz (depending on region)  
50 - 250 m depending on the radio frequency. Coverage is reduced by walls, large objects and other radio transmitters.

64 as standard. Up to 256 with optional software.  
For indoor and outdoor use in a protected location. Not water or rain proof.  
Maintenance free. Clean with a dry cloth. Don't use household cleaners, aerosol sprays, solvents, alcohol, ammonia, or abrasives. Not reusable.

If your Push button transmitter appears to be damaged or doesn't function properly, follow the advice in this booklet and the online resources. If it still doesn't function properly, contact your retailer to obtain warranty service.

For warranty information and conditions, visit [bellman.com](http://bellman.com).

-10° - 40° C, 14° - 104° F  
-10° - 50° C, 14° - 122° F  
15% - 90% (non condensing)

Visit Sender als Funk-Türklingel oder Personrufaste (kompatibel mit allen Empfängern)  
Das Produkt kann Innen- und im geschützten Außen-Bereich verwendet werden.  
Es ist Spritzwasser geschützt, aber nicht Wasserdicht.  
Mit trockenem oder leicht feuchtem Tuch abwischen

Wartungsfrei! Batterie kann ausgetauscht werden. Sollte der Sender trotz neuer Batterie nicht ordnungsgemäß funktionieren, muss das Gerät zur Reparatur eingesandt werden.  
Für Informationen zu den Garantie Bestimmungen und deren Abwicklung wenden Sie sich bitte an Ihren Fachhändler Vorort.  
Batterie 6 V PX28L Lithium oder 6 V PX28G/PX28M Alkali

Das Produkt ist nicht für den Wiedereinsatz für eine andere Person vorgesehen.

## FCC compliance statement

This device complies with Part 15 of the FCC Rules. Operation is subject to the following two conditions: (1) This device may not cause harmful interference, and (2) This device must accept any interference received, including interference that may cause undesired operation.

FCC ID: 2APAKBE1240

**Warning:** Changes or modifications to this unit not expressly approved by the party responsible for compliance could void the user's authority to operate the equipment.

**Note:** This equipment has been tested and found to comply with the limits for a Class B digital device, pursuant to part 15 of the FCC Rules. These limits are designed to provide reasonable protection against harmful interference in a residential installation. This equipment generates uses and can radiate radio frequency energy and, if not installed and used in accordance with the instructions, may cause harmful interference to radio communications. However, there is no guarantee that interference

will not occur in a particular installation. If this equipment does cause harmful interference to radio or television reception, which can be determined by turning the equipment off and on, the user is encouraged to try to correct the interference by one or more of the following measures:

- Reorient or relocate the receiving antenna.
- Increase the separation between the equipment and receiver.
- Connect the equipment into an outlet on a circuit different from that to which the receiver is connected.
- Consult the dealer or an experienced radio/TV technician for help.

For a complete Declaration of Conformity please contact the Bellman & Symfon European office.

## Industry Canada statement

This device contains licence-exempt transmitter(s)/receiver(s) that comply with Innovation, Science and Economic Development Canada's licence-exempt RSS(s). Operation is subject to the fol-

lowing two conditions: (1) This device may not cause interference. (2) This device must accept any interference, including interference that may cause undesired operation of the device.

L'émetteur/récepteur exempt de licence contenu dans le présent appareil est conforme aux CNR d'Innovation, Sciences et Développement économique Canada applicables aux appareils radio exempts de licence. L'exploitation est autorisée aux deux conditions suivantes: (1) L'appareil ne doit pas produire de brouillage; (2) L'appareil doit accepter tout brouillage radioélectrique subi, même si le brouillage est susceptible d'en compromettre le fonctionnement.

This Class B digital apparatus complies with the Canadian ICES-003.  
IC: 6693A-BE1240

## Zusätzliche Information

Nur Innen verwenden. Wartungsfrei. Nur mit einem leicht feuchten Tuch reinigen.

HMV 16.99.09.0072



**GB** Personal alarm

**DE** Personen-Notsignal

**FR** Alarme personnelle

**NL** Persoonlijk alarm

**ES** Alarma personal

**IT** Allarme personale

**PT** Alarme pessoal

**GR** Προσωπικός συναγερμός

**SE** Personalarm

**NO** Personlig alarm

**DK** Personlig alarm

**FI** Henkilökohtainen hälytys

**PL** Alarm osobisty

**CZ** Osobní alarm

**HU** Személyi riasztó

**SRB** Lični alarm

